

PART #118, 118A 1957 Key Cylinder into Ignition Switch

Instruction Sheet Master

Revised 10/2018



To remove the lock and cylinder, insert the key into the switch assembly, position the switch in the "LOCK" position and insert a large paper clip into upper small hole on cylinder face (see diagram 1). Push in on the paper clip to depress the brass spring pin and continue to turn the key counterclockwise until the lock cylinder can be removed.

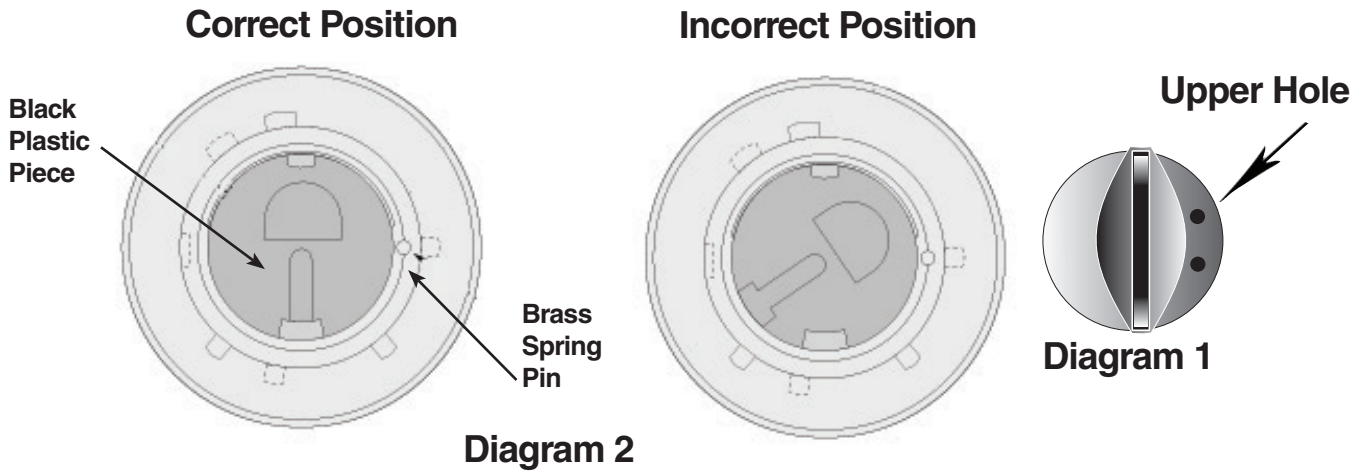

NOTE: There is a black plastic piece within the ignition switch into which the end of the key cylinder fits. This black plastic piece must be aligned with its outer metal housing as shown. If it is not aligned properly, insert a screwdriver into the half-moon shaped depression and rotate until it is aligned in the correct position. If the black plastic part is in any other position the key cylinder will not click into place (See diagram 2.) To install key and tumbler into ignition switch, slide the key and tumbler (with key inserted in tumbler) down until it stops and turn clockwise. Reconnect battery.

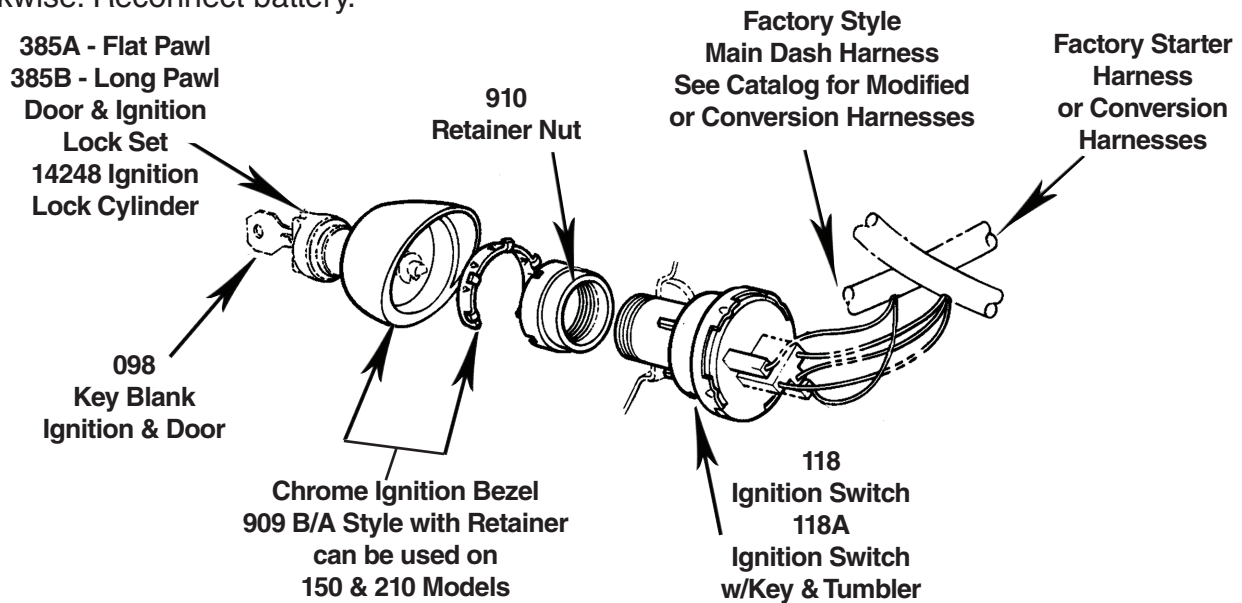

See #508 1957 Passenger Factory Assembly Manual for correct wiring instructions