

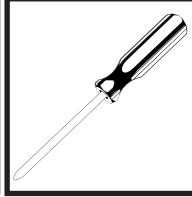

Tools needed:

1. Phillips head screw driver
2. Scratch awl tool
3. Razor

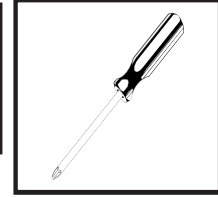
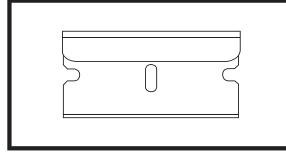

It is recomened to have a friend to help with the installation.

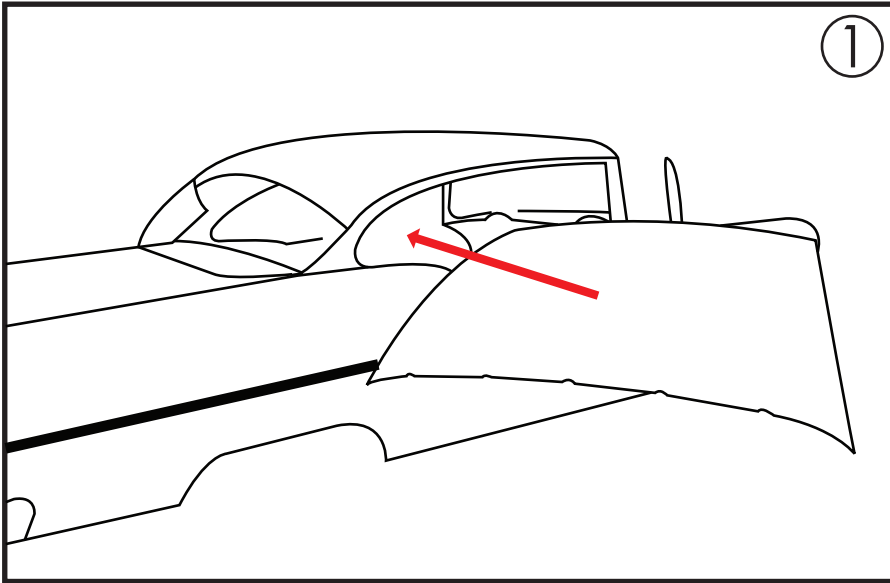

①

Step 1: Getting the headliner in the car. on non-post cars the easist way to get the headliner in is to roll down both windows and fit the headliner in through the passenger side. It is important to get the headliner into the car with the fiberglass towards the roof. Once the liner is in the car you must fit the headliner into place. The easiest way to do this is by lining the notches in the fiberglass in the front and rear to the holes they belong to on the roof of the car. Take special care for key features like a rear view mirror location to help you center the headliner. Once the headliner is in place you may hold it in place while a friend continues onto the next step or use a prop to hold the headliner in place.

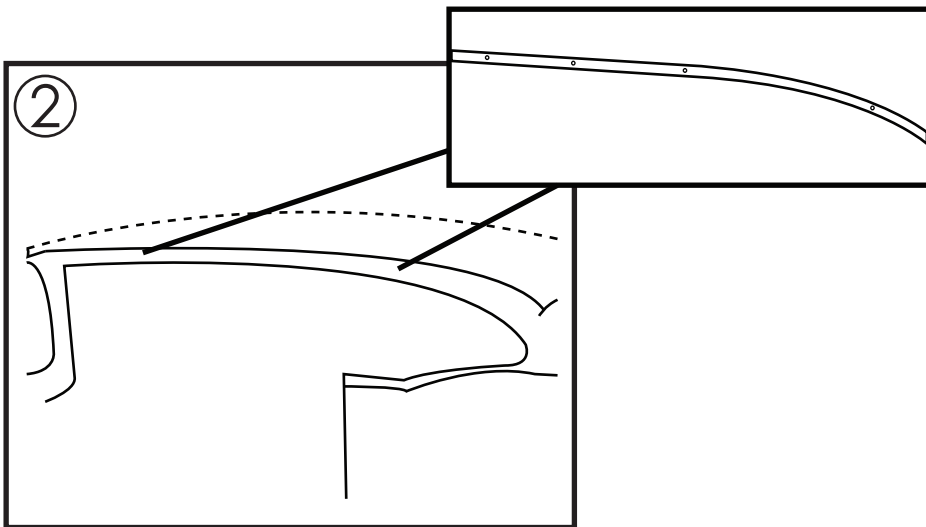

②

Step 2: Once the headliner is postioned you can install the headliner side trim panels. The headliner will have recessed cuts in it to locate the screw locations. Using a scratch awl tool you can poke through the vinyl to locate the screw location. We suggest doing the screw at the front and rear first. This helps locate the other screws. You will repeat this step on the other side.They re-install the same way they would go in factory

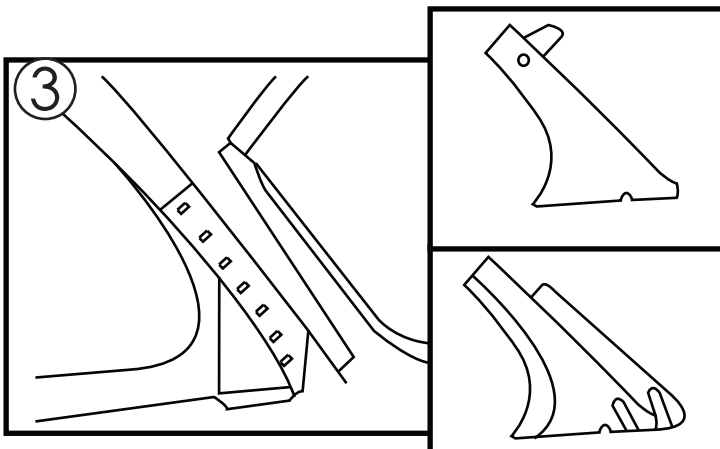

③

Step 3: Once all the screws are installed into the side trim pieces you will install the B-Pillar trim pieces. Trim piece with more curves is the base plate and the rounder trim piece goes over and covers a majority of the base piece. They re-install the same way they would go in factory

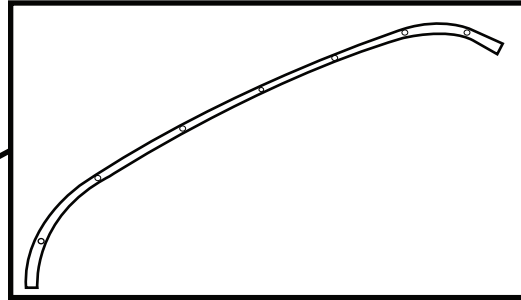
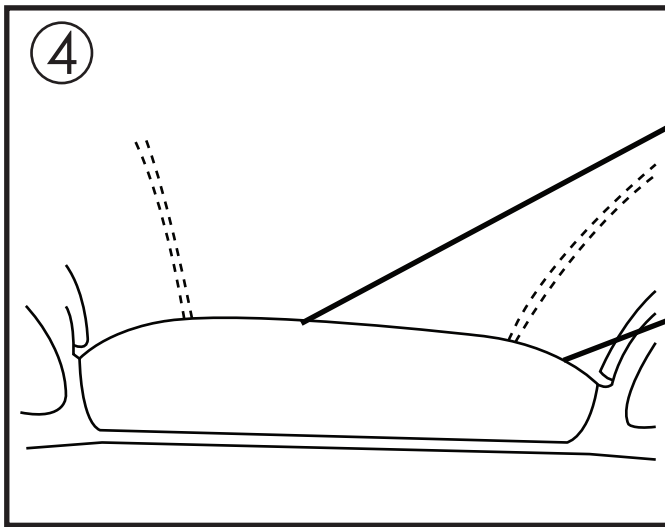

Step 4: After the B-Pillar trim pieces are installed you can now re-install the rear window trim piece. This piece goes in the same way it would from factory. Like the side trim pieces we recommend that

you use a scratch awl tool to find the screw holes. Once the holes is found start at the two corner screws and work your way inward. Doing it out side to inside helps line up the other screw holes.

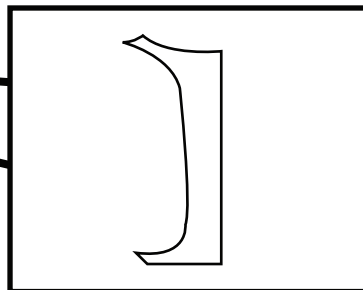
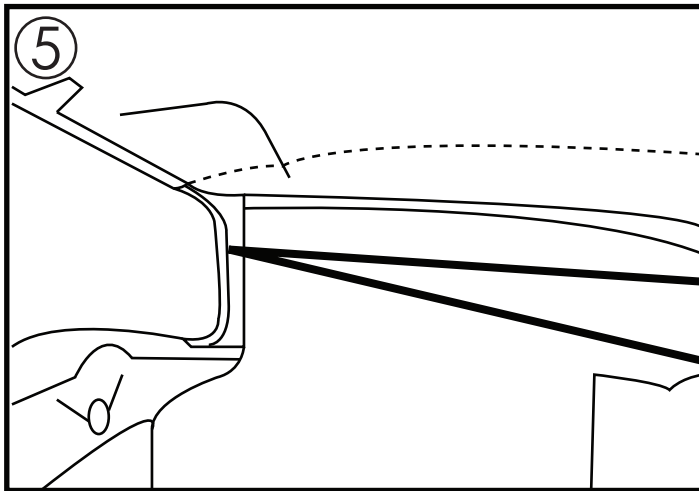

Step 5: Once the rear window trim piece is installed you can install the A-Pillar trim piece. They re-install the same way they would go in factor securing the bottom screw first. The top screw you will need to use scratch awl tool to locate the screw hole location on the other end of the vinyl.

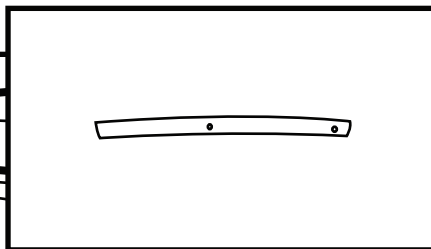
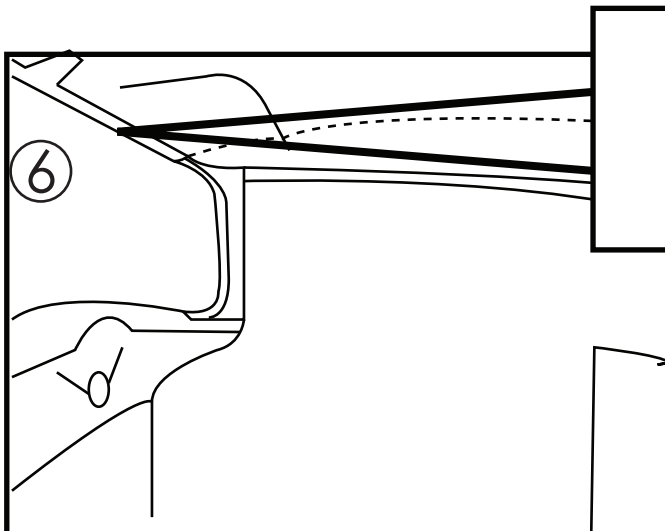

Step 6: The final piece of trim work to install is the trim pieces at the front of the headliner that will be placed in between the A-Pillar trim pieces and the rear view mirror area. They re-install the same way they would go in factory. Using the Scratch awl tool locate the screw holes and simply screw them into place.

Step 6: Re-installing Rear view mirror, sunvisors and dome lights. For the rear view mirror and sunvisors using the scratch awl tool locate the screw holes and install them the same as factory. For the dome lights locate the domlight location and cut a small "X" at the vinyl. Using the scratch awl tool locate the screw holes and fit the dome light in and screw it in.